

Bloomfield Hills - Governor's Place Building - 2,016 Sq. Ft



PROPERTY ADDRESS:

33 Bloomfield Hills Parkway
Suite 280
Bloomfield Hills, MI 48304

SUITE SIZE: 2,016 Sq. Ft.

AVAILABLE: Immediately

FLOORPLAN: See page 2

LEASE RATE: \$25.00 PSF - general office

LEASE TERM: Negotiable

DEMOGRAPHICS:

Oakland County, MI:

Population (2015): 1,243,970

Median household income (2015): \$67,465

Median house value (2015): \$178,900

Bloomfield Hills, MI:

Population (2015): 42,112

Median household income (2015): \$112,154

Median house value (2015): \$350,600



SUITE DESCRIPTION:

- 3 windowed offices
- Large reception, upon entry
- Admin area
- Conference room
- IT room
- Coffee room
- Windows that provide fresh air
- Convenient and ample parking

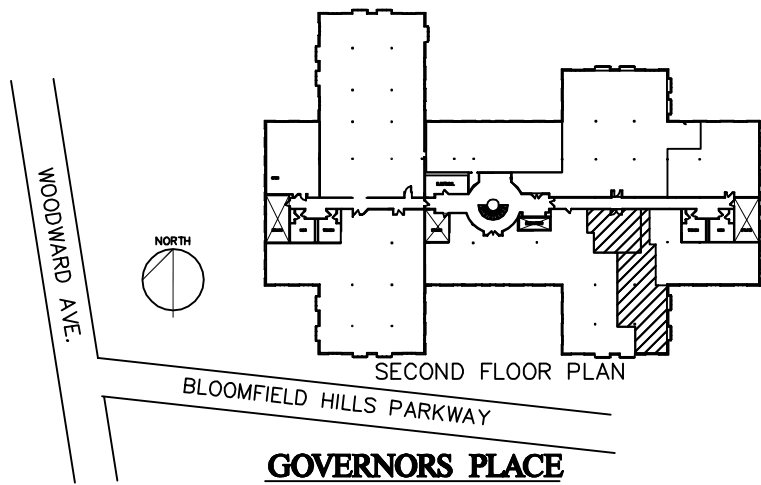

GOVERNORS PLACE

33 BLOOMFIELD HILLS PARKWAY
BLOOMFIELD HILLS, MI.
AVAILABLE FOR LEASE
SUITE #280
APPROX. 2,016 R.S.F.
4-25-2013

