

## Bingham Farms - Jamestowne 31000 Building - 1,294 Sq. Ft



**PROPERTY ADDRESS:**

31000 Telegraph Road  
Suite 240  
Bingham Farms, MI 48025

**SUITE SIZE:** 1,294 Sq. Ft.

**AVAILABLE:** Immediately

**FLOORPLAN:** See page 2

**LEASE RATE:** Negotiable

**LEASE TERM:** 5 year term

**DEMOGRAPHICS:**

***Oakland County, MI:***

Population (2015): 1,243,970  
Median household income (2015): \$67,465  
Median house value (2015): \$178,900

***Bingham Farms, MI:***

Population (2015): 1,133  
Median household income (2015): \$102,083  
Median house value (2015): \$361,500



**SUITE DESCRIPTION:**

Nice smaller office available that features:

- Entry into lobby area
- 2 windowed offices
- A corner conference room
- Storage/file room
- An employee lounge

Other features include:

- Windows that open
- Individual control over the HVAC
- Plenty of convenient parking

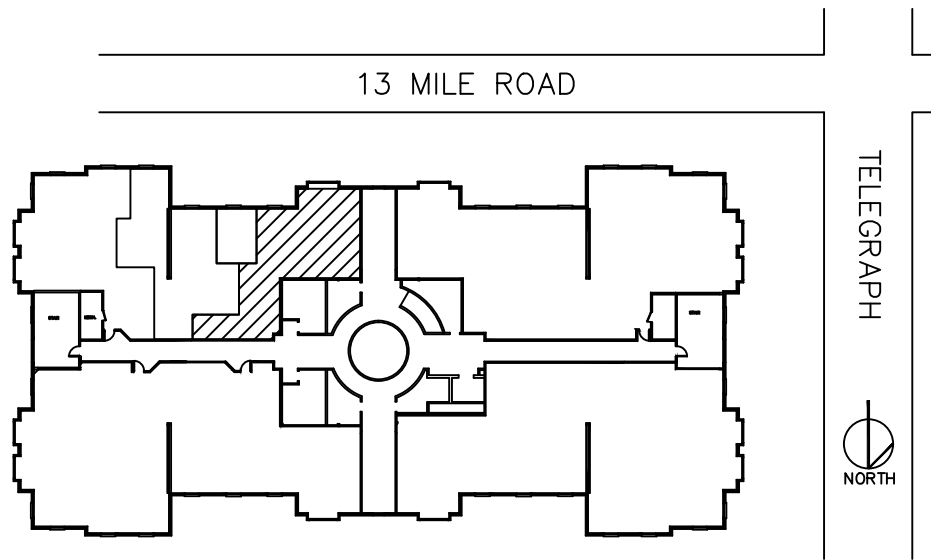

JAMESTOWNE EXECUTIVE OFFICES  
 31000 TELEGRAPH ROAD, BINGHAM FARMS, MI.  
 AVAILABLE FOR LEASE  
 APPROX. 1,294 R.S.F.  
 SUITE 250  
 4-9-2021

